

# Specification Sheet

Max Interrupt Voltage: 130 Vac  
 Max Operating Voltage: 60 Vdc  
 Maximum Interrupt Current: 20 A

Insulating Material:  
 meets UL94 V-0 Requirements

Lead-free, RoHS compliant

Lead Material:  
 Tin plated copper, 0.5 Dia.

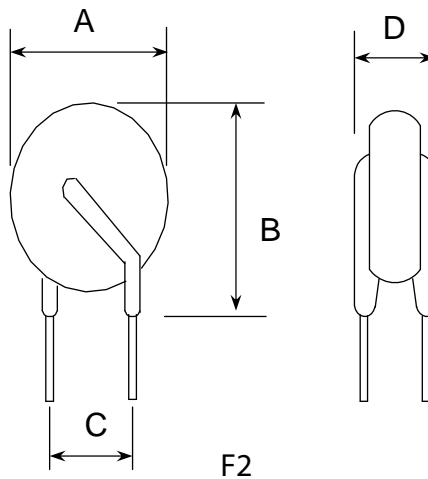

**TABLE I. DIMENSIONS:**

	A	B	C	D	LEAD
	MAX	MAX	TYP	MAX	TYP
mm	8.3	10.7	5.1±0.5	3.8	F2

**TABLE II. PERFORMANCE RATINGS:**

Model	$V_{max}$ (Vac)	$I_{max}$ (A)	$I_{hold}$ @25°C (A)	$I_{trip}$ @25°C (A)	Maximum Time To Trip		Resistance	
					Current (A)	Time (Sec)	Ri min (Ω)	Ri max (Ω)
Bp080-130	130	20	0.08	0.16	0.24	15.0	8.00	24.00