

Specification

P Product Name: SMD5050 Module with lens

It Item No: OLLBN.0.3W3-yi-6s

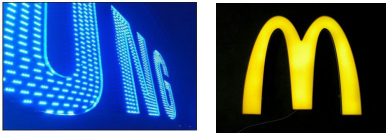

Applications

Suitable for 8 ~ 12cm [2.36 ~ 3.15in] depth signs such as channel letters, metal letters, light boxes, decoration, etc.

Features

1. High luminous efficacy 5050 SMD LED mounted, each LED reach **20-22LM**.
2. High light effective; No light decay after working 1000Hrs; With 50000Hrs lifespan.
3. Overmolded housing design with 160degree len, wide beam angle, nice and upscale.
4. Adopt aluminum PCB board, good heat sink, which extend the lifetime of module.
5. Certification: CE, RoHs
6. constant current driving.

Installation

1. **3M** adhesive tape backing on modules used as an installation aid only, permanent adhesion is done with screws;
2. Single module as a unit can be cut accordingly.
3. The maximum quantity can be connected in one row is 40pcs.

Warranty

3 years warranty, 50,000H life span

Technical Parameters:

Item No.	LED Color	Color Temperature(K)	Beam Angle (°)	Luminous Flux (lm)	Working Voltage (V)	Power (W)	Dimension (mm)
OLLBN.0.3W3-yi-6s	Pure White	6000-6500	160	60-66	12	0,72	66.8*15.8*7

Others:

Item No.	LED Color	Standard Qty per string (pcs)	Storage Temp (°)	Working Temp (°)	Material	Net Weight (g)	IP Rank
OLLBN.0.3W3-yi-6s	All	20	- 25~+70	- 20~+60	ABS	7,6	IP65

Profile Drawings:

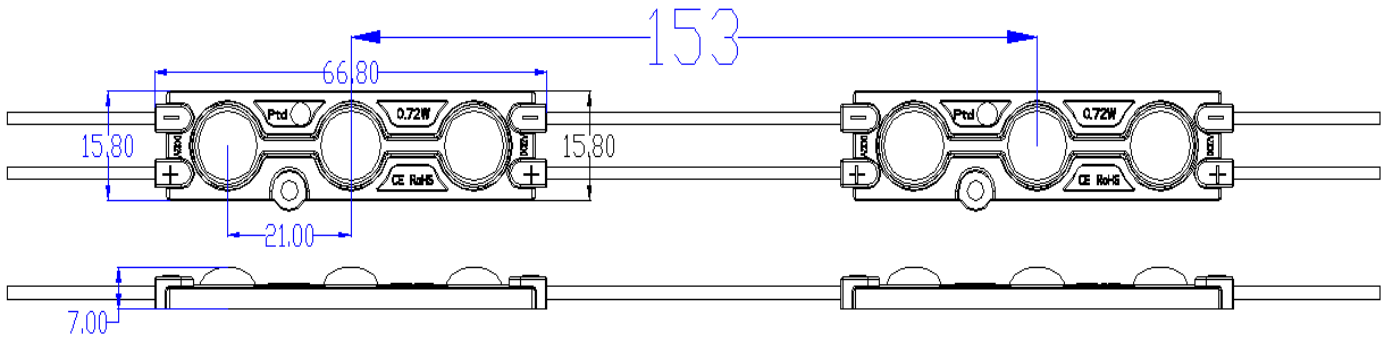

Package:

100pcs

2000pcs

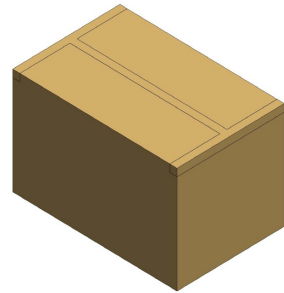
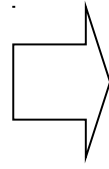
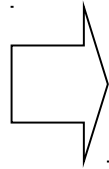

1. Carton Dimension: 50.5*28*34cm=0.048 CBM (1±10%) [19.88*11.02*13.38in];
2. 20 modules per string, 5 strings per bag, 20 bags per outer carton, 2000 modules in total;
3. Net Weight (N.W) : 16.5KG (1±10%)
4. Gross Weight (G.W): 17.5KG (1±10%)
5. The actual packed quantity and weight subject to change without prior notice.