

1 2 3 4 5 6 7 8 9

ROHS

文件编号:		版次:	A/0
修订日期:		备注:	

**SPECIFICATIONS**

**Current Rating:3Amp**

**Insulation Resistance:1000MΩ Min**

**Contact Resistance:20mΩ**

**Withstanding voltage: AC 500V min**

**Operating Temperature -40℃ to +105℃**

**Materials**

**Contact Material:copper Alloy and GOLD FLASH**

**Insulation Material:polyester. UL94-0 PBT**

**Color:BLACK**

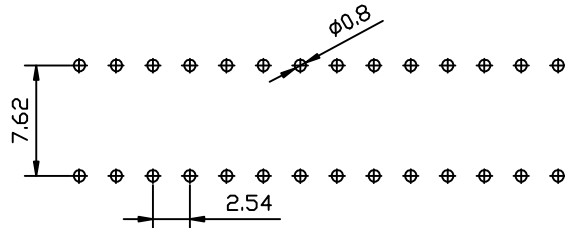
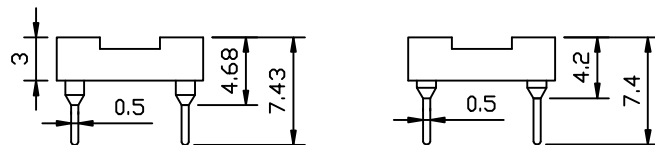
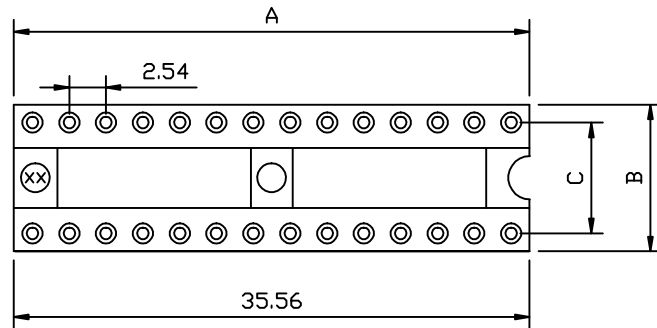

PCB LAYOUT

No. of pins	A	B	C	No. of pins	No. of pins	A	B	C	No. of pins
6	7.62	10.16	7.62	100-XXX-063-DA	28	35.56	12.70	10.16	100-XXX-284-DA
8	10.16	10.16	7.62	100-XXX-083-DA	32	40.64	12.70	10.16	100-XXX-324-DA
10	12.70	10.16	7.62	100-XXX-103-DA					
12	15.24	10.16	7.62	100-XXX-123-DA	24	30.48	17.78	15.24	100-XXX-246-DA
16	20.32	10.16	7.62	100-XXX-163-DA	28	30.56	17.78	15.24	100-XXX-286-DA
18	17.78	10.16	7.62	100-XXX-183-DA	32	40.64	17.78	15.24	100-XXX-326-DA
20	22.86	10.16	7.62	100-XXX-203-DA	40	50.80	17.78	15.24	100-XXX-406-DA
24	30.48	10.16	7.62	100-XXX-243-DA	42	53.34	17.78	15.24	100-XXX-426-DA
28	35.56	10.16	7.62	100-XXX-283-DA	48	60.96	17.78	15.24	100-XXX-486-DA
					50	63.50	17.78	15.24	100-XXX-506-DA
20	25.40	12.70	10.16	100-XXX-204-DA					
22	27.94	12.70	10.16	100-XXX-224-DA					
24	30.48	12.70	10.16	100-XXX-244XDA					

客户名称

比例 (SCALE)	free	绘图 (DRAW)	pingquan
单位 (UNIT)	MM	审核 (CHECK)	
GENERAL TOLERANCE	X	±0.30	
	X X	±0.25	
	X XX	±0.15	



厂商料号 (DRAW NO)	06.01.2008
品名 (DRAW)	IC 圓孔214P 2.54 行距7.62
出图日期	2015-04-02

1 2 3 4 5 6 7 8 9